

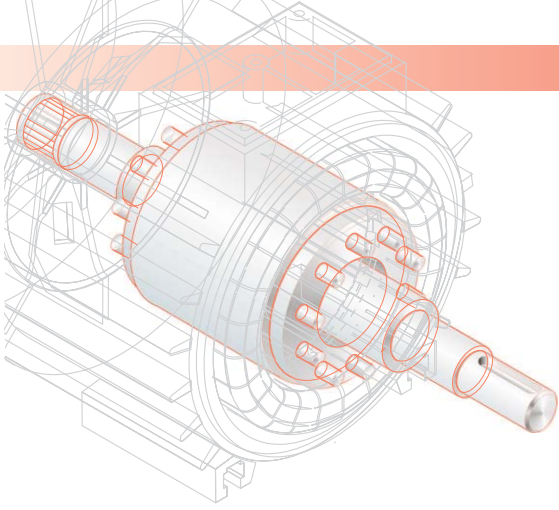

BESEL S.A.

FABRYKA SILNIKÓW ELEKTRYCZNYCH



()

:

- S1; ;

- 230 (1-) 3 230/400 (3-);

- 50 ; () 1- 2-

() ,

3- (3 400).

	[]	[]	[]	[-1]	U _n [A]	- [3/]
1-						
PO-56	220/240	50/60	14,5/14	2350/2850	0,07/0,06	0,014
PO-63	220/240	50/60	14,5/14	2350/2850	0,07/0,06	0,014
PO-71	230	50	70	2880	0,31	0,066
PO-80	230	50	70	2880	0,31	0,077
PO-90R	230	50	70	2880	0,31	0,127
3-						
PO-71	400	50	50	2950	0.25	0,066
PO-80	400	50	50	2950	0.25	0,077
PO-90R	400	50	50	2950	0.25	0,127

	L1 []	L2 []	AC []	HB []
PO-56	117	57	110	98
PO-63	136	82	120	103
PO-71	204	63	134	114
PO-80	197	67	150	122
PO-90R	189	51	165	129

56, 63

IP54.

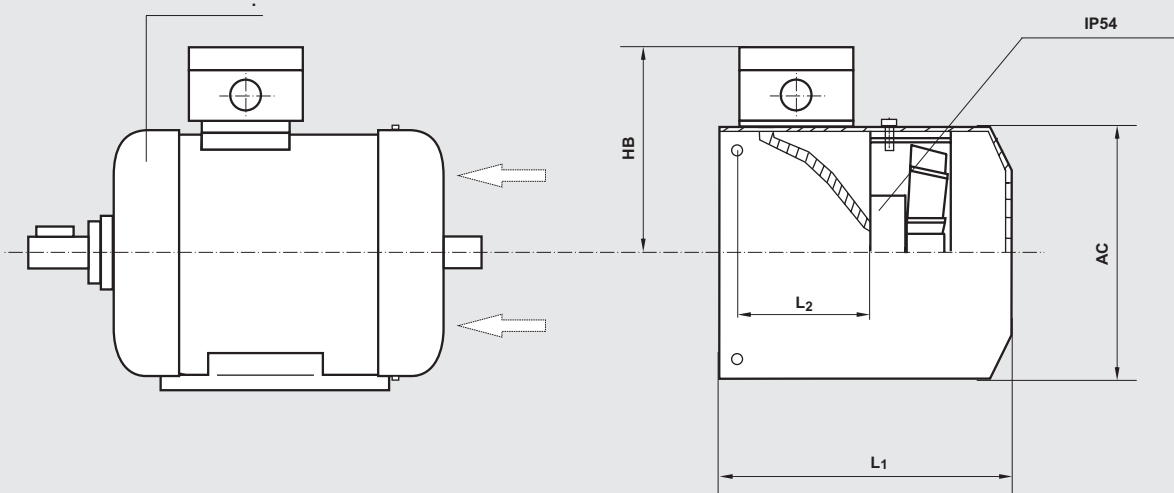

71, 80, 90 90R

IP54, IP55 (IP56).

